

4 Chadley Close, Solihull, B91 2DD
£135,000 Cash Only

Key features

First floor apartment
Communal entrance hall
Reception hall
Living room
Fitted kitchen
Inner hallway
2 bedrooms
Bathroom
Separate WC
Gas fired warm air central heating
Double glazing
Garage in separate block
Communal gardens
No chain
Leasehold

Overview

4 Chadley Close is a well presented, 2 bedroom, first floor apartment, most conveniently situated in this highly popular residential area and benefitting from no upward chain.

Tenure

We have been advised that the property is LEASEHOLD, with 46 years unexpired (99 years from 24.06.65), there is a current annual service charge of £1389 and annual ground rent of £40. However, you should check this with your legal advisor before exchanging contracts.

Local Authority

Solihull Borough Council

First Floor

Approx. 74.1 sq. metres (797.8 sq. feet)

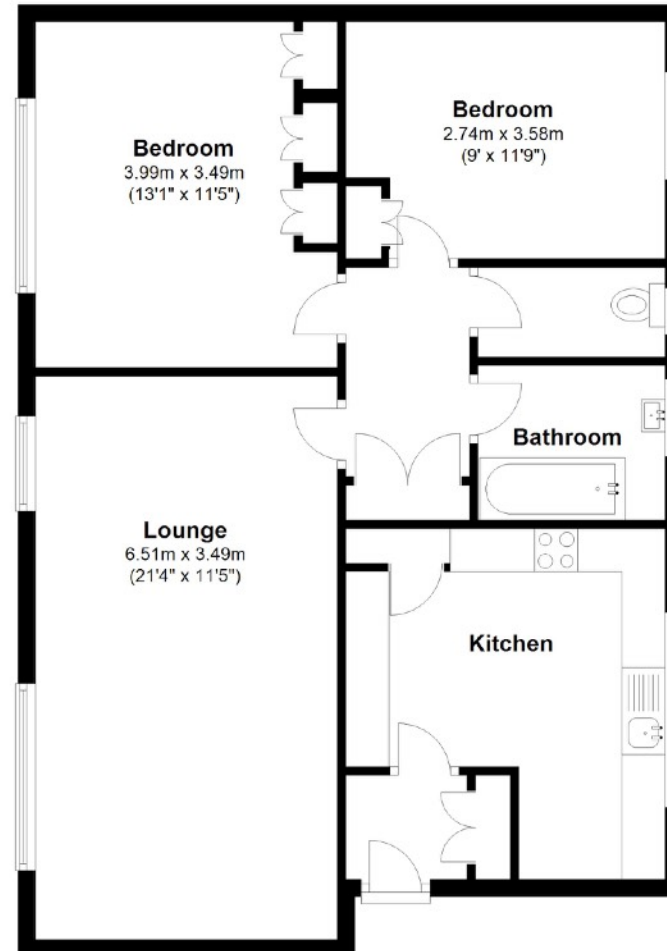

Total area: approx. 74.1 sq. metres (797.8 sq. feet)





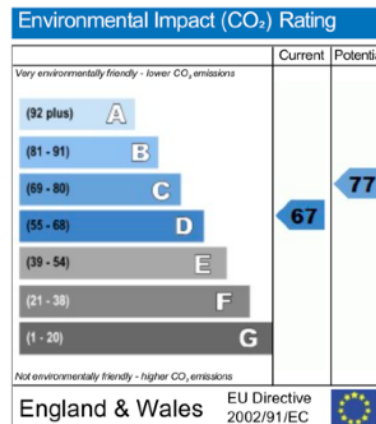
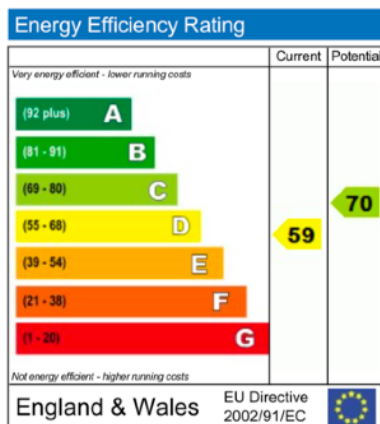

Viewing Arrangements
 Simon Burt The Estate Agent
 0121 705 4040



These particulars do not constitute part or all of an offer or contract.

The measurements indicated are supplied for guidance only and as such must be considered incorrect.

Potential buyers are advised to recheck the measurements before committing to any expense.

Simon Burt The Estate Agent have not tested any apparatus, equipment, fixtures, fittings or services and it is the buyer's interests to check the working condition of any appliances.

Simon Burt The Estate Agent has not sought to verify the legal title of the property and the buyers must obtain verification from their solicitor.