



15 Redlands Close, Solihull B91 2LY

www.simonburthomes.co.uk

£190,000

KEY FEATURES

Entrance Porch / Reception Hall
Through Lounge
Re-Fitted Dining Kitchen
Lobby / Utility
Three Bedrooms / Re-Fitted Bathroom
Gas Central Heating / Double Glazing
Rear Garden
No Upward Chain

15 Redlands Close is a well proportioned, three bedroom, traditional, end town house family home, set behind a communal green in this highly popular residential area being a short walking distance of Solihull Town Centre.

Tenure

We have been advised that the property is FREEHOLD. However, you should check this with your legal advisor before exchanging contracts.

Local Authority

Solihull Metropolitan Borough Council

Vendors Comments

This property has been our family home for 4 years. We were originally attracted to the property due to its location – including its close proximity to Solihull Town Centre, the excellent choice of Schools in the catchment area and three good sized bedrooms.

Upon living here we have found that it is set within a quiet and friendly neighbourhood with excellent local amenities, the house is very functional and the rear garden has the sun all day!!

When we bought the house it was very old and required a lot of improvement. We have spent a lot of time and effort modernising the property; replastering, redecorating every room and refitting the kitchen and bathroom. We will be sad to leave and hope that the house provides as much enjoyment for someone else.

Local Schools

Yew Tree Primary School
Greswold Primary School
Solihull School
Lode Heath School

Viewing Arrangements

Telephone: 0121 705 4040 Email: sales@simonburthomes.co.uk Visit: www.simonburthomes.co.uk

Energy Efficiency Rating

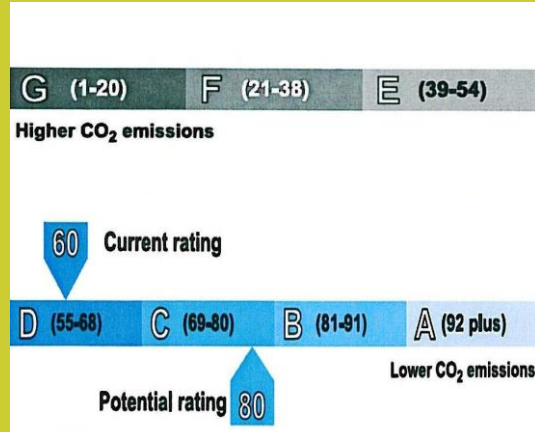
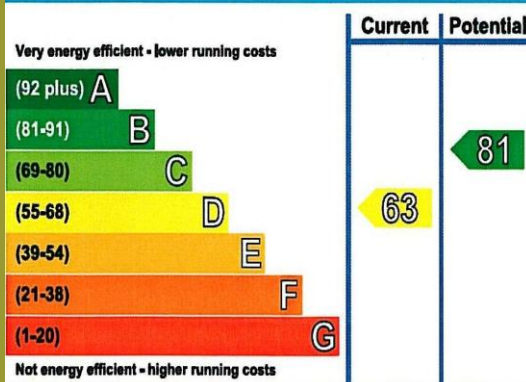

First Floor
Approx. 41.5 sq. metres (446.4 sq. feet)

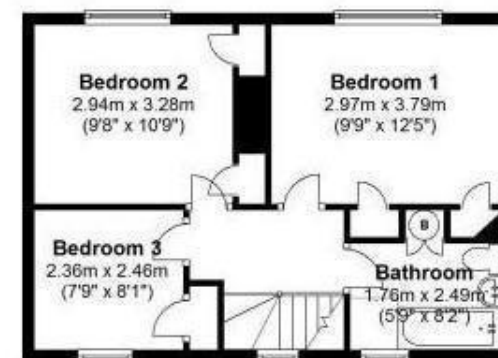

Total area: approx. 93.4 sq. metres (1004.8 sq. feet)

These particulars do not constitute part or all of an offer or contract. The measurements indicated are supplied for guidance only and as such must be considered incorrect. Potential buyers are advised to recheck the measurements before committing to any expense. Simon Burt The Estate Agent have not tested any apparatus, equipment, fixtures, fittings or services and it is the buyer's interests to check the working condition of any appliances. Simon Burt The Estate Agent has not sought to verify the legal title of the property and the buyers must obtain verification from their solicitor.

