



65 Middlewood Close, Solihull B91 2TZ

£300,000

www.simonburthomes.co.uk

Key Features

Three-Storey Accommodation
 Reception Hall / Guest Cloakroom
 Fitted Breakfast Kitchen
 Full-Width Lounge on the First Floor
 Dining Room on the Ground Floor
 Four Bedrooms
 En-Suite Shower Room
 Family Bathroom
 Gas Central Heating / Double Glazing
 Two Numbered Parking Spaces Adjacent to the Property
 Foregarden / Rear Garden

65 Middlewood Close is an attractive, modern, four bedroomed, three-storey, family town house residence, occupying a delightful end of cul-de-sac location in this conveniently situated residential development.

Tenure

We have been advised that the property is FREEHOLD. However, you should check this with your legal advisor before exchanging contracts.

Vendor's Comments

We were amongst the first occupants on this vibrant development having bought off-plan in 2006. We then watched as the rest of the estate evolved around us.

The adjacent canal-side park is ideal for dog walking and the location is well situated being local to Solihull town centre and within easy reach of Birmingham International and Solihull stations, Birmingham airport, the NEC and motorway interchange.

We have been impressed by the spacious room sizes and excellent sound insulation (we assume our neighbours have television, but you would never know!)

We only feel the need to move now as our requirements have changed and we hope the next family to live here enjoy the house as much as we have.

Ground Floor

Approx. 41.5 sq. metres (446.8 sq. feet)

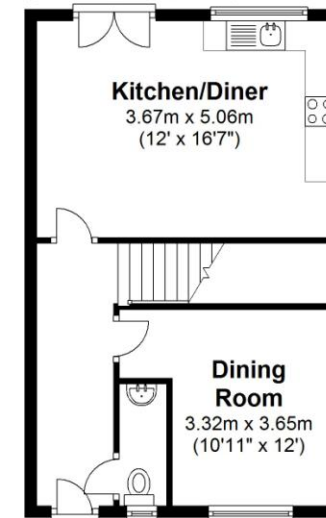

First Floor

Approx. 41.5 sq. metres (446.8 sq. feet)

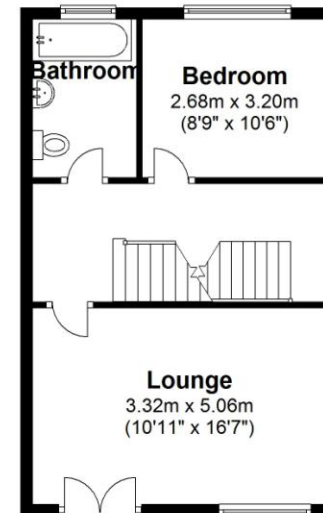

Second Floor

Approx. 40.4 sq. metres (435.1 sq. feet)

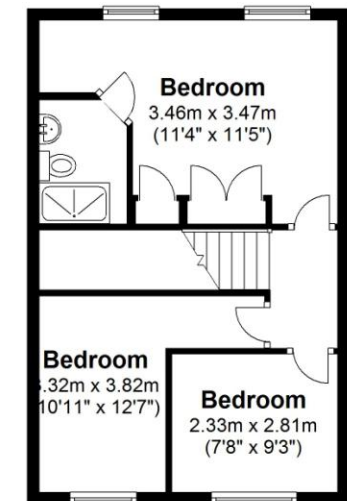

Viewing Arrangements

Telephone: 0121 705 4040 Email: sales@simonburthomes.co.uk Visit: www.simonburthomes.co.uk

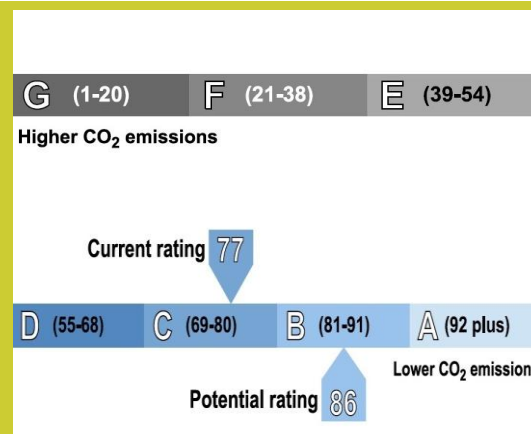
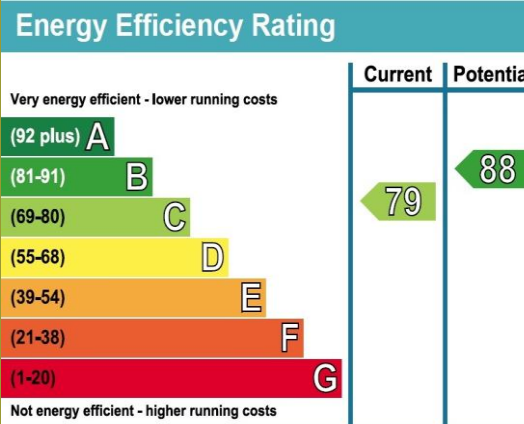

Total area: approx. 123.4 sq. metres (1328.8 sq. feet)

These particulars do not constitute part or all of an offer or contract. The measurements indicated are supplied for guidance only and as such must be considered incorrect. Potential buyers are advised to recheck the measurements before committing to any expense. Simon Burt The Estate Agent have not tested any apparatus, equipment, fixtures, fittings or services and it is the buyer's interests to check the working condition of any appliances. Simon Burt The Estate Agent has not sought to verify the legal title of the property and the buyers must obtain verification from their solicitor.



