



112 Moorlands Drive, Shirley, Solihull B90 3RE

£300,000

www.simonburthomes.co.uk

Key Features

Entrance Porch / Reception Hall
 Living Room / Breakfast Kitchen
 Inner Hallway / Three Bedrooms
 En-Suite Shower Room
 Family Bathroom
 Gas Central Heating / Double Glazing
 Sheltered Side Entry
 Enclosed Carport / Driveway Parking
 Substantial Rear Garden
 No Chain

112 Moorlands Drive is a deceptively spacious, three bedroomed, link-detached, bungalow residence, enjoying a substantial rear garden situated in this quiet highly popular residential cul-de-sac.

Tenure

We have been advised that the property is FREEHOLD. However, you should check this with your legal advisor before exchanging contracts.

Vendor's Comments

Our wonderful bungalow was built by the original developer specifically for his daughter. Therefore it has a few extra 'bells and whistles' not seen in the surrounding homes. Most obvious of these are the significantly bigger plot on which our home stands and the carport and workshop to the side of the property.

Our neighbourhood of cul-de-sacs is a close-knit community of largely retired professionals who keep an eye out for each other.

Local Schools

Blossomfield Infant and Nursery School
 Shirley Heath Junior School
 Tudor Grange Primary Academy
 Streetsbrook Infant and Nursery School

Local Authority

Solihull Metropolitan Borough Council

Viewing Arrangements

Telephone: 0121 705 4040 Email: sales@simonburthomes.co.uk Visit: www.simonburthomes.co.uk

Ground Floor

Approx. 136.7 sq. metres (1471.8 sq. feet)

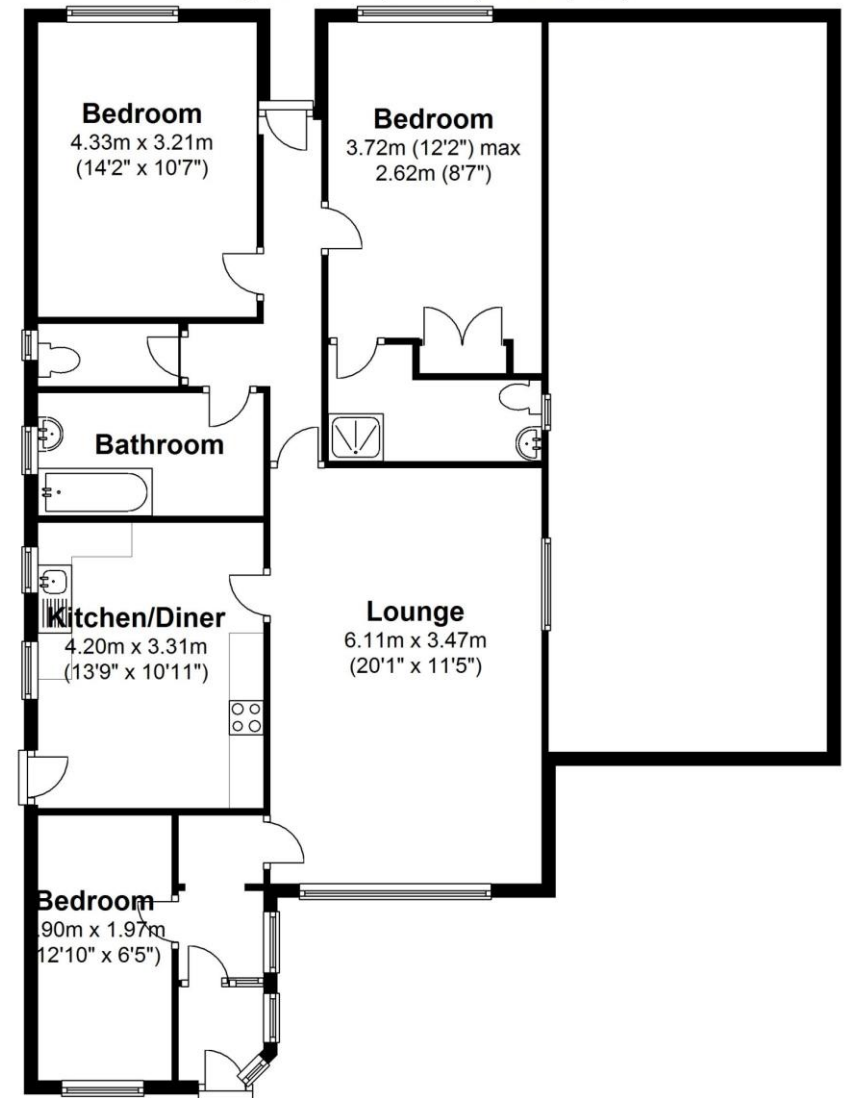

Total area: approx. 136.7 sq. metres (1471.8 sq. feet)

These particulars do not constitute part or all of an offer or contract. The measurements indicated are supplied for guidance only and as such must be considered incorrect. Potential buyers are advised to recheck the measurements before committing to any expense. Simon Burt The Estate Agent have not tested any apparatus, equipment, fixtures, fittings or services and it is the buyer's interests to check the working condition of any appliances. Simon Burt The Estate Agent has not sought to verify the legal title of the property and the buyers must obtain verification from their solicitor.

Energy Efficiency Rating

